

Rolfe East



Hamilton Road, Ealing, London, W5 2EE

£375,000

- One double bedroom
- Excellent condition
- Gas central heating
- No upper chain
- Ground floor flat
- High ceilings
- Communal gardens
- EPC rating: C / Council tax band: D

With high ceilings and period features this one double bedroom ground floor apartment is presented in an excellent condition throughout and features wood flooring, gas central heating, modern kitchen and bathroom, large double bedroom, no upper chain and a large well kept communal garden.



Council Tax Band: D



Hamilton Road, W5

Approx. Gross Internal Area 432 Sq Ft - 40.13 Sq M

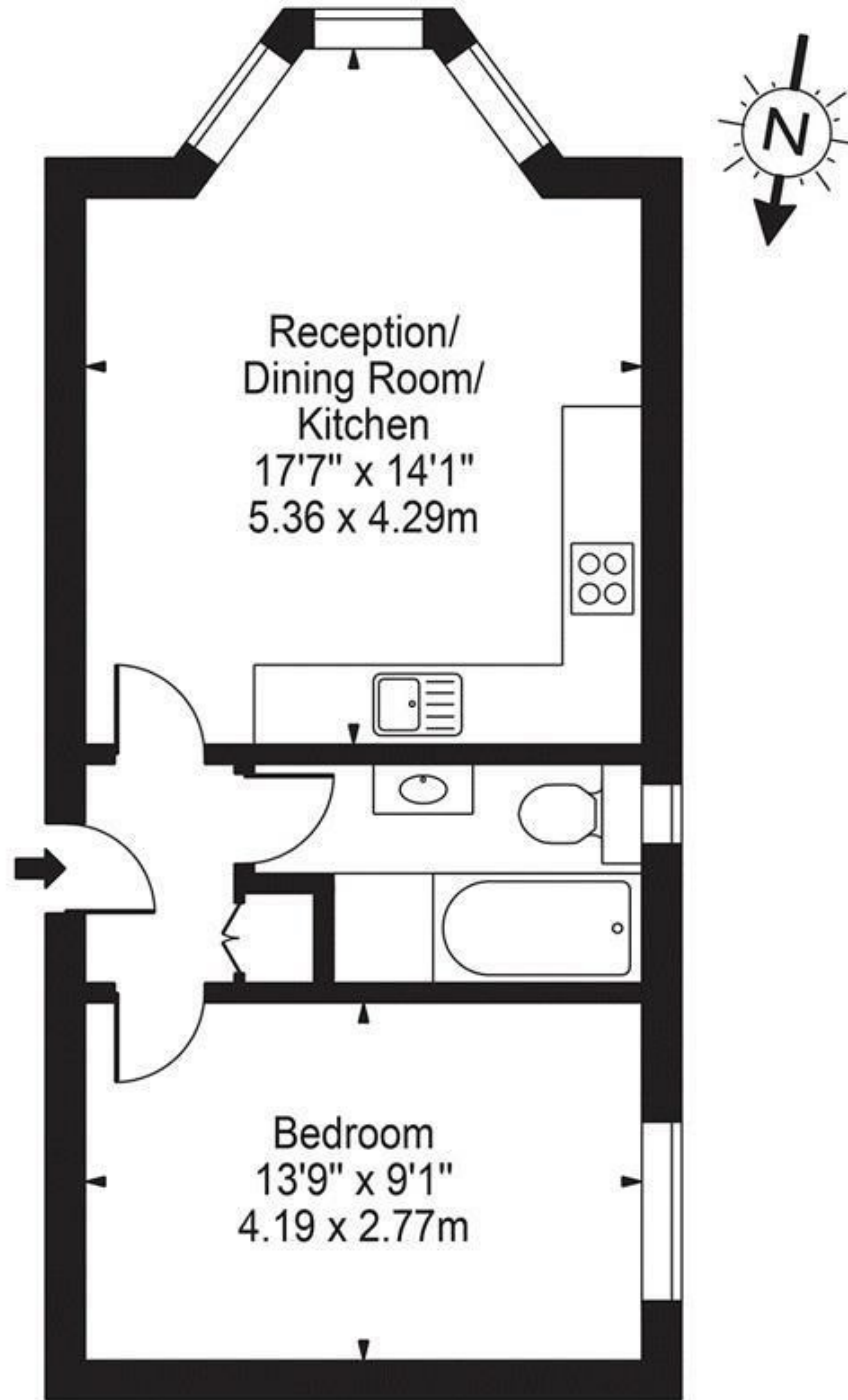

Ground Floor

For Illustration Purposes Only - Not To Scale Floor Plan by Mira Nikolova Photography

This floor plan should be used as a general outline for guidance only and does not constitute in whole or in part an offer or contract.
Any intending purchaser or lessee should satisfy themselves by inspection, searches, enquiries and full survey as to the correctness of each statement.
Any areas, measurements or distances quoted are approximate and should not be used to value a property or be the basis of any sale or let.

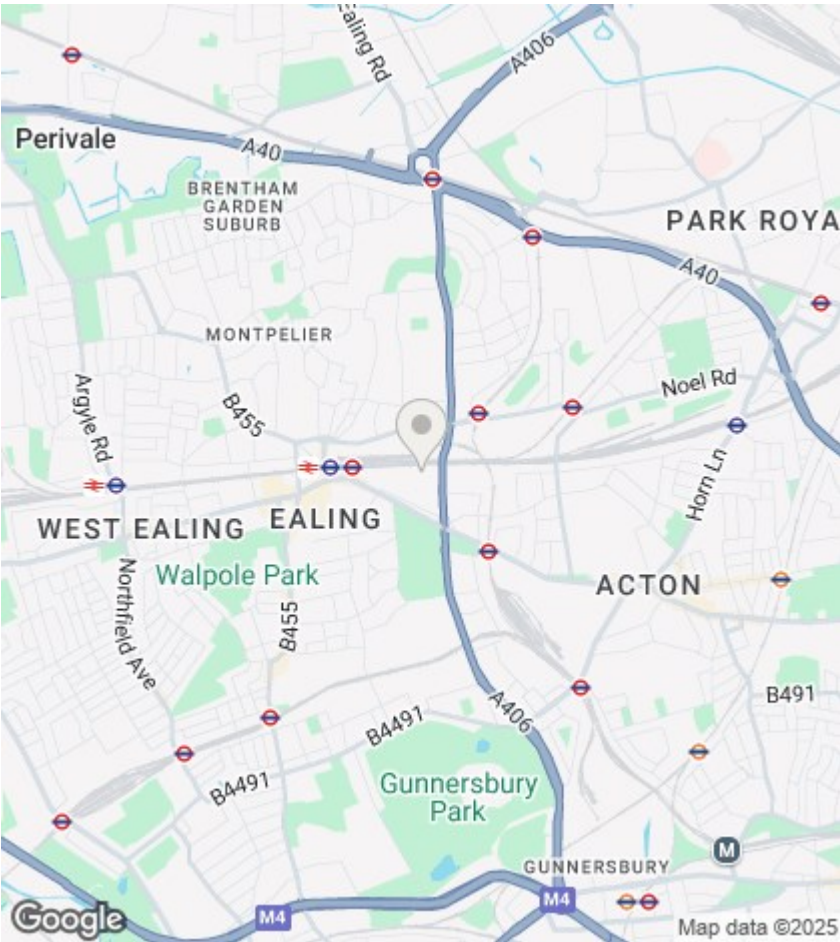

Directions

Viewings

Viewings by arrangement only. Call 020 8567 2242 to make an appointment.

EPC Rating:
C

Energy Efficiency Rating		
	Current	Potential
Very energy efficient - lower running costs		
(92 plus) A		
(81-91) B		
(69-80) C	76	76
(55-68) D		
(39-54) E		
(21-38) F		
(1-20) G		
Not energy efficient - higher running costs		
England & Wales		EU Directive 2002/91/EC